

6 DEALER MANUAL FOR H400 (FM G312.250.D)



CONTENT

6.1 Introduction	2	6.3 Drive Unit Installation	4
6.2 Specifications	3	6.3.1 List of Tools to be used	4
6.2.1 Outline and geometric size	3	6.3.2 Motor Installation	4
6.2.2 Surface	3	6.4 Maintenance	5
6.2.3 Storage Information	3		

6.1 INTRODUCTION



- **Product Model**

FM G312.250.D

- **Scope**

i Applies only to electrically powered pedelecs developed or licensed by Bafang. It is suitable for city and trekking bikes, which have been developed for road use. The engine is not suitable for sport competitions.

- **Identification**

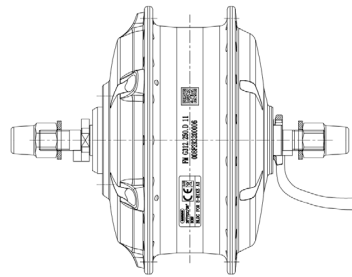

The following graphic, is the identification numbers of the product, which are shown on the housing:



Note: Content in the label is important information about this product. Please do not remove the information from the motor.

6.3 DRIVE UNIT INSTALLATION

6.3.1 List of Tools to be used

Use of the Tools	Tools
To fasten BC3/8 cap lock nuts	 Open-end wrench
To fasten the screws on disk brake	 Internal hex wrench

6.3.2 Motor Installation

1. First fix the disc brake on to non-cable side of the motor and insert the stop pin on to the shaft.

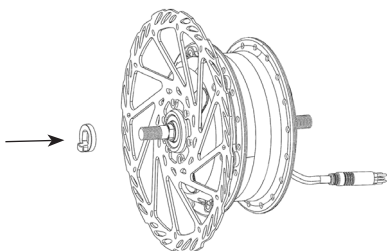

2. Insert the motor into the frame.

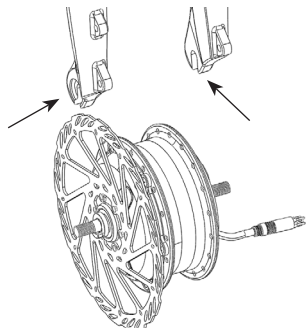

3. Mount one 2mm washer on both sides of the frame.

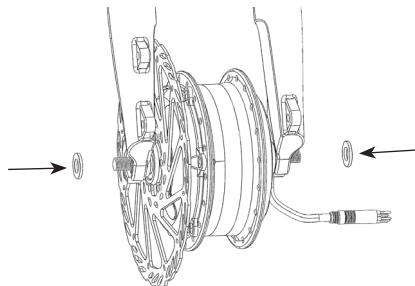

4. Fasten clockwise BC3/8 cap lock nut with open-end wrench at both ends of the motor. Torque requirement: 30-36N.m.

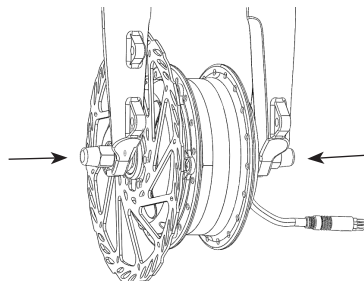

6.4 MAINTENANCE

- Maintenance must be carried out by authorized personnel with the correct equipment.
- Do not disassemble the motor.
- Do not use thinners or other solvents to clean the components. Such substances can damage the surfaces.
- Avoid water submerging, to keep the components protected.
- Avoid using high-pressure cleaning jets.
- For prolonged storage, turn off the battery and avoid storing near heat sources.